

# LEVEL FOUR

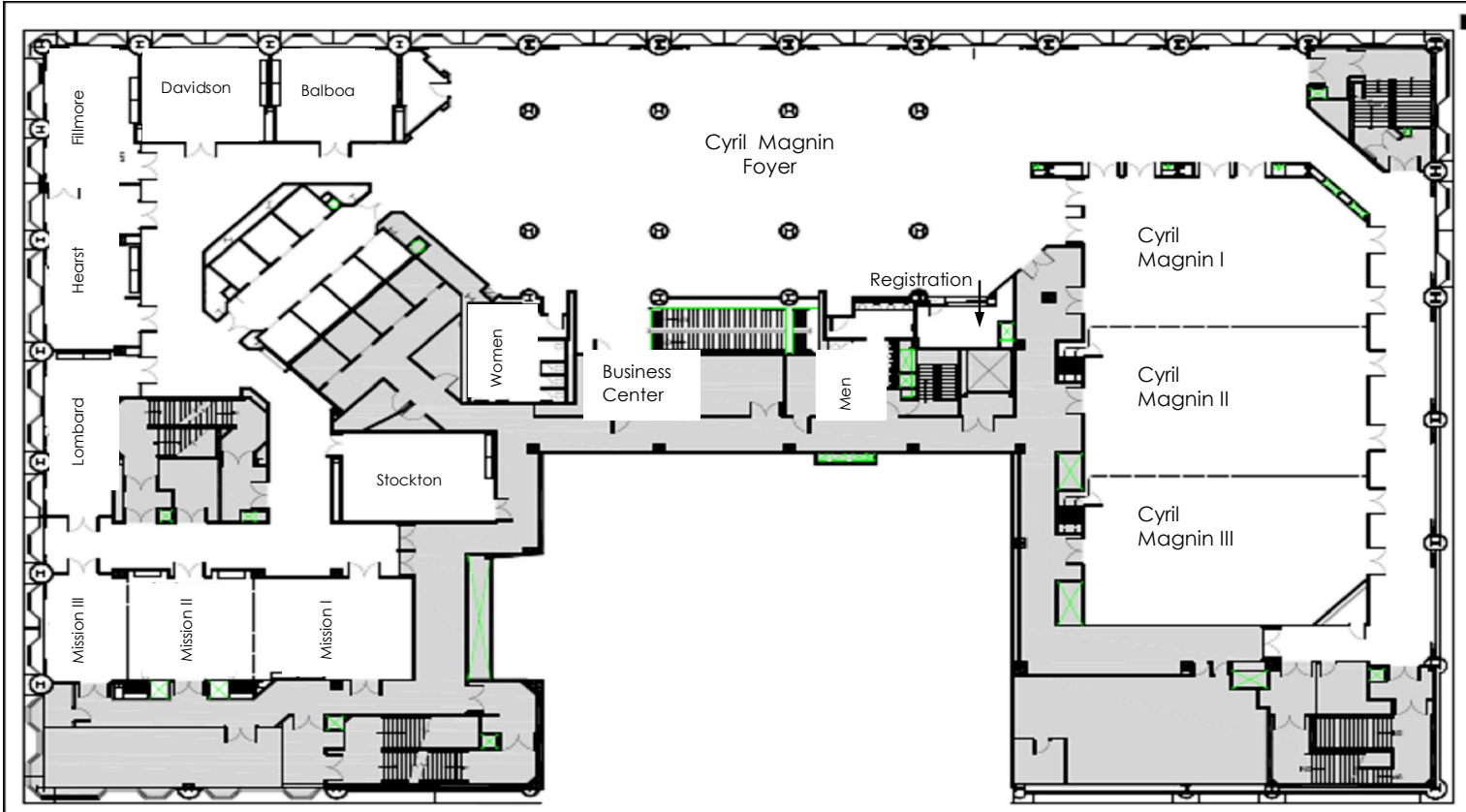

FORM MEETS FUNCTION IN A VARIETY OF SPACES FOR INTIMATE EVENTS OR GRAND GALAS ON THE FOURTH LEVEL. DÉCOR, LIGHTING AND SPACE FLOW IS DESIGNED TO EXPRESS THE AMBIANCE OF SAN FRANCISCO'S FAMOUS STREETS AND OFFER A UNIQUE BACKDROP. THE EXPANSIVE FOYER AND SMALLER SESSION SPACES OFFER LARGE WINDOWS OVERLOOKING THE CITYSCAPE.



LEVEL FOUR											
Meeting Room	Dimension	Square Footage	Ceiling Height	Classroom (3 Per 8')	Classroom (4 Per 8')	Conference	Hollow Square	Reception	Rounds	Theater	U-Shape
<b>Cyrl Magnin Ballroom</b>	55'x103'	5,670	12'6"	255	400	120	100	1000	550	900	90
Cyril Magnin I	55'x34'	1,890	12'6"	81	108	65	66	300	170	211	60
Cyril Magnin II	55'x35'	1,925	12'6"	84	112	65	66	300	180	225	60
Cyril Magnin III	55'x34'	1,890	12'6"	81	108	65	66	300	170	211	60
<b>Cyrl Magnin Foyer*</b>	57'x120'	6,840	12'0"					1200	370		
Balboa	22'x25'	550	8'10"	24	32	24	24	50	27	60	20
Davidson	22'x25'	550	8'10"	24	32	24	24	50	44	60	20
Fillmore	19'x31'	589	8'10"	21	28	26	24	50	44	55	20
Hearst	19'x37'	703	8'10"	18	28	30	30	60	50	60	27
Lombard	14'x37'	518	8'10"	15	28	30	24	40	33	55	27
Stockton	30'x20'	600	8'10"	30	40	30	30	50	50	60	26
<b>Mission</b>	24'x71'	1,704	8'10"	66	100	50	58	200	120	160	58
Mission I	24'x31'	744	8'10"	24	32	32	34	75	66	70	34
Mission II	24'x25'	600	8'10"	18	24	24	24	50	44	50	24
Mission III	24'x15'	360	8'10"	12	16	20	22	24	30	30	20

*Capacities do not include audio visual. Total square footage of Cyril Magnin Foyer is 7,912 including all surrounding pre-function.*

55 Cyril Magnin Street, Market at Fifth, San Francisco, CA 94102

**T** 415.392.8000 **F** 415.403.6602 [www.parc55hotel.com](http://www.parc55hotel.com)